

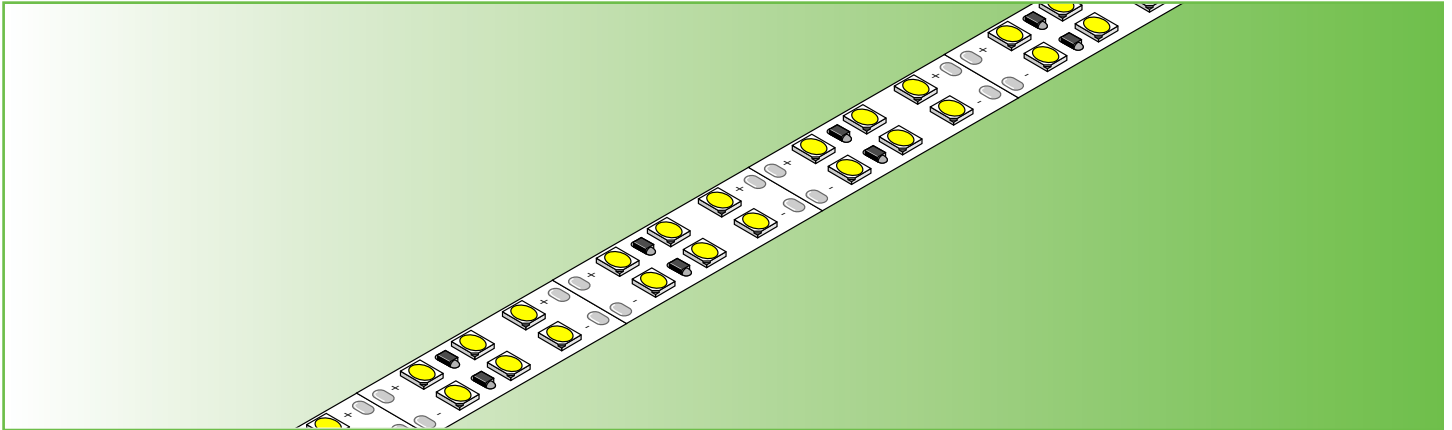

Item # _____

Project _____



DI-24V-DB	
Voltage/Wattage	24VDC / 5.75W/ft.
Lumens¹	2700K 500 Lm/ft.
	3000K 500 Lm/ft.
	3500K 510 Lm/ft.
	4200K 520 Lm/ft.
	5000K 525 Lm/ft.
Max. Run²	16.4 feet
Cut Points	2 in.
LED Chips	72/foot

DI-24V-DB	
Color Temperature	2700, 3000, 3500, 4200, 5000
CRI	80+
Dimmable	Yes
Field Cuttable	Yes
Dimensions	.6 in. x .1 in.
Environment*	Indoor / IP20
Certification	UL Listed 2108
Warranty	12-Year Warranty

*WARNING: NOT FOR USE IN SUBMERSIBLE APPLICATIONS

FEATURES

- High Lumen output
- Extended run lengths

SKU Builder

DI	-	24V	-	DB	-	
		Voltage		Model		Color Temp
						Length
						27
						30
						35
						42
						50
						16'
						100'
						CSTM ³ (Length)

Example: DI-24V-DB35-16 = Diode, 24 Volt, DOUBLE BLAZE™ Tape Light, 3,500° CCT, 80+ CRI, 16.4 foot spool.

24V DOUBLE BLAZE™ LED Tape Light

SPECIFICATION SHEET

SPECIFICATIONS

- Input: 24VDC Constant Voltage
- LED Chip Type: 3528
- LED Chip Beam Angle: 120°
- Luminous Efficacy⁴ (lm/w): 87-91
- Mounting: 3M™ 55280 Adhesive
- Connections: 3 ft. Female DC plug on end. 3 ft. hard-wire lead opposing end. Leads: 20/2 AWG.
- Ambient Temp⁵: -4 - 122°F (-20 ~ 50°C)
- Operating Temp⁶: -4 - 176°F (-20 ~ 80°C)

CHANNEL MOUNTING?

Note: Double Blaze LED Tape Light is compatible with all Chromapath Builder and Bundle Channels with the exception of Chromapath Builder DUO Channels, and Chromapath Bundle SCONCE Cannels.

COMPLIANCE & REGULATORY APPROVALS

Safety

- UL Listed 2108. UL 1598 / CSA 250.0-08, UL 8750. UL 879 / CAN/CSA-C22.2 no. 207-M89. E469769 (UL Listed), E469770 (Component Recognized).

Performance

- LED chip data measured in accordance to IES LM-80-08.
- Photometric & Colorimetry data measured in accordance to IES LM-79-08, in Elemental LED's Innovation Lab.

COMPATIBLE DRIVERS

Additional information on compatible Drivers can be found on page 5-6 or on the Diode LED web site at: www.DiodeLED.com.

SPECIFYING?

Note: The compatible products listed in this Specification Sheet are provided for reference only. For complete specifications of compatible products, click on the [SPEC SHEET](#) links provided.

1. Lumen value measured in accordance to IES LM-80-08. LED chips have a luminous flux range with a tolerance of +/- 5%.
2. Each maximum run requires a dedicated power feed from the driver. Do not extend beyond the recommended maximum run length.
3. Requests for custom lengths of Strip Light will be cut to the nearest (*lower*) cut point. (*Example: DI-24V-DB35-CSTM-15' 3" would be cut to 182 inches (ie. 15' 2")*)
4. Actual efficacy value is dependent to specified LED driver (power supply). An estimated efficacy value can be calculated as follows: Lumen value divided by average power consumption per foot.
5. Do not install product in an environment outside the listed ambient temperature. Exceeding the maximum ambient temperature may damage LED chips, reduce the total lamp life, lumen output, and/or adversely impact color consistency.
6. Operating temperature is measured according to the minimum and maximum ambient temperature environment.

24V DOUBLE BLAZE™ LED Tape Light

SPECIFICATION SHEET

MECHANICAL DIAGRAMS

24V DOUBLE BLAZE™ LED Tape Light

DI-24V-DB

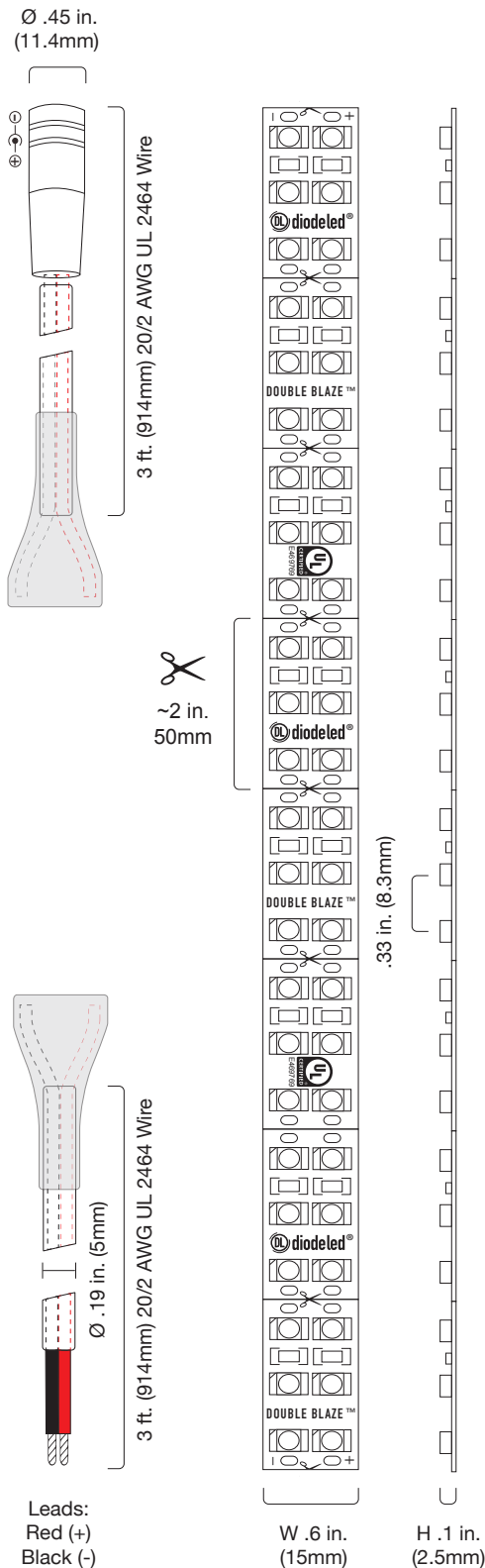

ADDITIONAL ACCESSORIES

Accessories listed below are fully compatible with our DOUBLE BLAZE™ LED Tape Light product line. Further information on these products and more accessories can be found in our latest catalog or online at www.DiodelED.com.

DOUBLE BLAZE™ Splice Connector

Connects DOUBLE BLAZE™ LED Tape Light to power supply. Refer to Installation Guide for further information.

Dimensions: 3.0 x 0.8 in. (L x W)

DI-0811

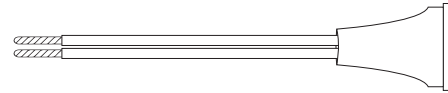

DOUBLE BLAZE™ DC Plug Connector

Connects DOUBLE BLAZE™ LED Tape Light to plug in adapter.

Dimensions: 3.0 x 0.8 in. (L x W)

DI-0812

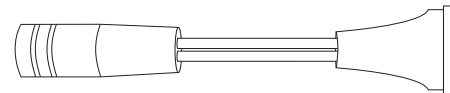

DOUBLE BLAZE™ Flexible Extension

Attaches two sections of tape light together. Wire lead allows for turns around tight corners.

Dimensions: 3.0 x 0.8 in. (L x W)

DI-0813



DOUBLE BLAZE™ Tape Link

Attaches two sections of tape light together.

Dimensions: 0.5 x 0.8 in. (L x W)

DI-0814



24V DOUBLE BLAZE™ LED Tape Light

SPECIFICATION SHEET

COMPATIBLE CHANNELS

CHROMAPATH® BUNDLE
20mm ROUNDED CORNER Channel

DI-CPCHB-RC20-48 [SPEC SHEET](#)

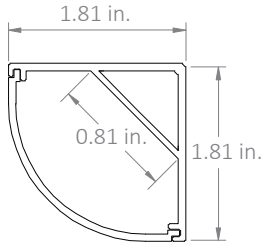

CHROMAPATH® BUNDLE
20mm SQUARE CORNER Channel

DI-CPCHB-SQC20-48 [SPEC SHEET](#)

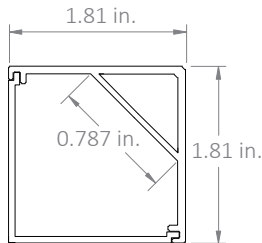

CHROMAPATH® BUNDLE
DOME Channel

DI-CPCHB-DOME-48 [SPEC SHEET](#)

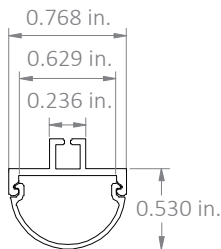

Chromapath® Bundle: DOME Channel is compatible with custom cut and soldered DOUBLE BLAZE™ LED Tape Light only.

DOUBLE BLAZE™ connectors will not fit within this channel.

CHROMAPATH® BUNDLE
RECESSED Channel

DI-CPCHB-REC-48 [SPEC SHEET](#)

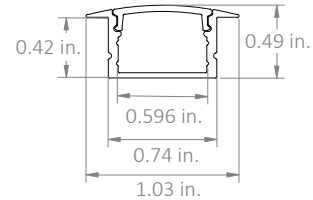

Chromapath® Bundle: RECESSED Channel is compatible with custom cut and soldered DOUBLE BLAZE™ LED Tape Light only.

DOUBLE BLAZE™ connectors will not fit within this channel.

CHROMAPATH® BUNDLE
SCONCE Channel

DI-CPCHB-SCNC-48 [SPEC SHEET](#)

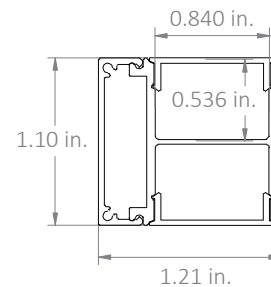

Chromapath® Bundle: SCONCE Channel is compatible with custom cut and soldered DOUBLE BLAZE™ LED Tape Light only.

DOUBLE BLAZE™ connectors will not fit within this channel.

24V DOUBLE BLAZE™ LED Tape Light

SPECIFICATION SHEET

COMPATIBLE CHANNELS

CHROMAPATH® BUILDER SLIM Channel

DI-CPCHA-SL

[SPEC SHEET](#)

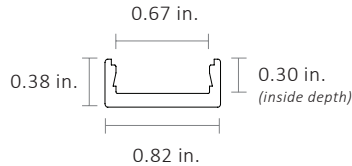

Chromapath® Builder: SLIM Channel is compatible with custom cut and soldered DOUBLE BLAZE™ LED Tape Light **only**.

DOUBLE BLAZE™ connectors will not fit within this channel.

CHROMAPATH® BUILDER SQUARE Channel

DI-CPCHA-SQ

[SPEC SHEET](#)

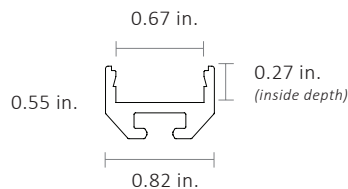

Chromapath® Builder: SQUARE Channel is compatible with custom cut and soldered DOUBLE BLAZE™ LED Tape Light **only**.

DOUBLE BLAZE™ connectors will not fit within this channel.

CHROMAPATH® BUILDER 45 DEGREE Channel

DI-CPCHA-45

[SPEC SHEET](#)

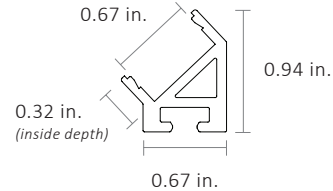

Chromapath® Builder: 45 DEGREE Channel is compatible with custom cut and soldered DOUBLE BLAZE™ LED Tape Light **only**.

DOUBLE BLAZE™ connectors will not fit within this channel.

CHROMAPATH® BUNDLE DUO Channel

DI-CPCHB-REC-48

[SPEC SHEET](#)

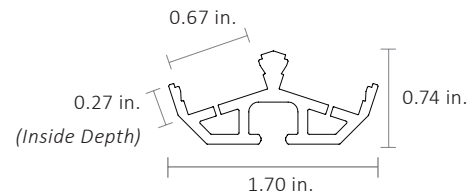

Chromapath® Builder: DUO Channel is compatible with custom cut and soldered DOUBLE BLAZE™ LED Tape Light **only**.

DOUBLE BLAZE™ connectors will not fit within this channel.

24V DOUBLE BLAZE™ LED Tape Light

SPECIFICATION SHEET

COMPATIBLE PRODUCTS

LED DRIVERS (Required)

The following Listed LED Drivers are recommended for compatibility and to meet NEC code when installed according to specifications. For additional LED Driver options see Diode LED's product page at: <https://www.diodeled.com/products/led-power-supplies.html>

SWITCHEX® DRIVER + DIMMER SWITCH

SWITCHEX combines an LED driver and LED dimmer switch into a single integrated unit. Fits into standard switch boxes.

[SPEC SHEET](#)

	Voltage Output		Power Output
DI	24V	SE	60W

SKU	L - LENGTH	W - WIDTH	H - HEIGHT
DI-24V-SE-60W	1.40 in.	2.10 in.	4.10 in.
DI-24V-SE-100W	1.40 in.	2.10 in.	4.10 in.

Fits in Standard Switch Box

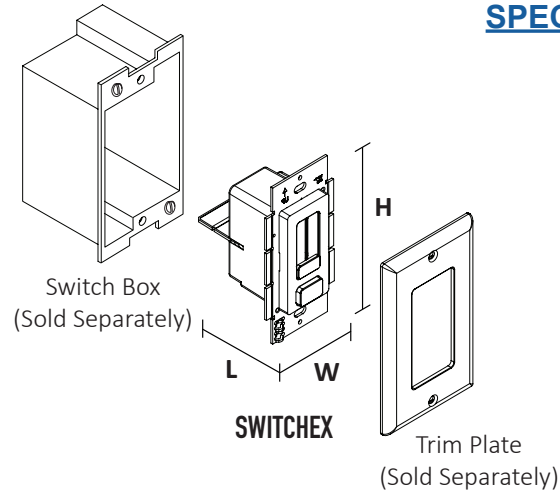

LO-PRO® JUNCTION BOX & DRIVER COMBO - 24V CONSTANT VOLTAGE LED DRIVER

Use Constant Voltage Drivers to power your lighting system. Compatible with Standard 120VAC On/Off Switches, REIGN® Low Voltage Dimmers, TOUCHDIAL™ Control System, DMX Decoders, and PWM Controls.

[SPEC SHEET](#)

	Voltage & Power Output	Junction Box
DI	0970	LPS

SKU	L - LENGTH	W - WIDTH	H - HEIGHT
DI-0970-LPS	11.25 in.	3.75 in.	1.90 in.
DI-CV-MW24V60W-277-LPS	11.25 in.	3.75 in.	1.90 in.
DI-CV-MW24V90W-277-LPS	11.25 in.	3.75 in.	1.90 in.
DI-0954-LPL	13.5 in.	4.5 in.	2.37 in.

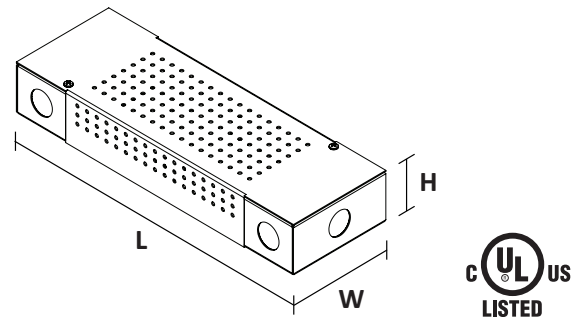

LO-PRO® JUNCTION BOX & DRIVER COMBO - 24V COMMERCIAL GRADE 0-10V LED DIMMABLE DRIVER

Compatible with 0-10V controls and dimming systems.

[SPEC SHEET](#)

	Voltage & Power Output		Junction Box
DI-DM	MW24V60W	0-10V	LPS

SKU	L - LENGTH	W - WIDTH	H - HEIGHT
DI-DM-MW24V60W-0-10V-LPS	11.25 in.	3.75 in.	1.90 in.
DI-DM-MW24V90W-0-10V-LPL	13.5 in.	4.5 in.	2.37 in.

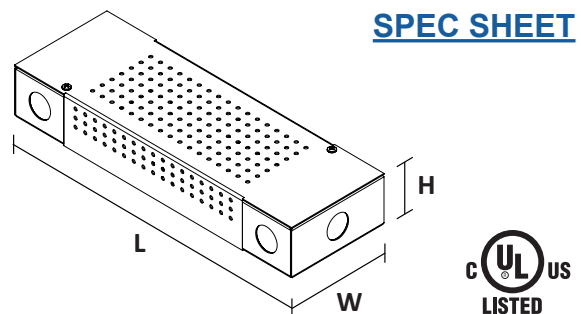

24V DOUBLE BLAZE™ LED Tape Light

SPECIFICATION SHEET

COMPATIBLE PRODUCTS

LED DRIVERS Cont. (Required)

The following Listed LED Drivers are recommended for compatibility and to meet NEC code when installed according to specifications. For additional LED Driver options see Diode LED's product page at: <https://www.diodeled.com/products/led-power-supplies.html>

OMNIDRIVE® 2 ELECTRONIC DIMMABLE LED DRIVER

OMNIDRIVE 2 features a zero minimum load and 100-5% dimming range. Compatible with Forward Phase and Reverse Phase Dimmers. Please see Diode LED's Compatibility List at: <https://www.diodeled.com/custom/download/productFile/fileName/DI-OD2-Compatibility%20List.pdf/>

[SPEC SHEET](#)

	Voltage & Power Output	
DI	OD2	24V24W

SKU	L - LENGTH	W - WIDTH	H - HEIGHT
DI-OD2-24V24W	13.75 in.	3.00 in.	1.60 in.
DI-OD2-24V60W	13.75 in.	3.00 in.	1.60 in.
DI-OD2-24V96W	15.00 in.	3.10 in.	2.40 in.
DI-OD2-24V120W	15.00 in.	3.10 in.	2.40 in.
DI-OD2-24V200W	16.10 in.	3.40 in.	2.40 in.

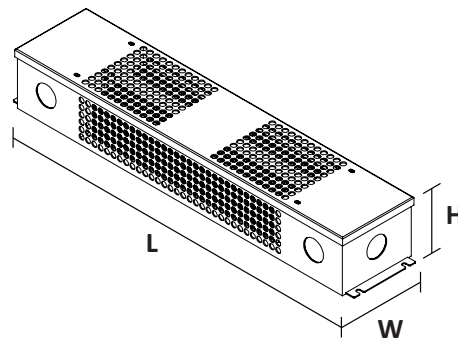

LUTRON® Hi-lume 1% LED DIMMABLE DRIVER

Hi-lume 1% LED Driver has a minimum load of 5W and dims from 100-1%.

	Voltage & Power Output	3-Wire or 2-Wire Dimmers
DI-DM	24V40W	L3D

SKU	L - LENGTH	W - WIDTH	H - HEIGHT
DI-DM-24V40W-L3D	4.89 in.	4.00 in.	2.62 in.
DI-DM-24V40W-LTE			

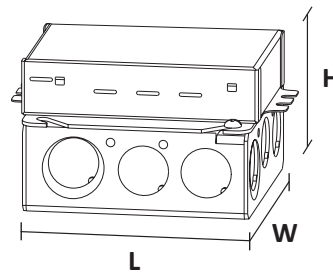

[L3D SPEC SHEET](#)

[LTE SPEC SHEET](#)



LUTRON® Hi-lume Premier 0.1% LED DIMMABLE DRIVER

Hi-Lume Premier 0.1% LED Driver has a minimum load of 5W and dims from 100-0.1%.

	Voltage & Power Output	
DI-DM	24V96W	L3D

SKU	L - LENGTH	W - WIDTH	H - HEIGHT
DI-DM-24V96W-L3D	5.50 in.	2.20 in.	10.50 in.

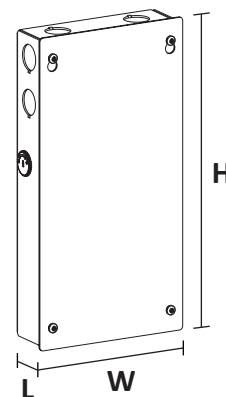

[SPEC SHEET](#)



24V DOUBLE BLAZE™ LED Tape Light

SPECIFICATION SHEET

ADDITIONAL INFORMATION

- 24V DOUBLE BLAZE™ LED TAPE LIGHT Installation Guide

SAFETY / WARNINGS / DISCLOSURES

1. Install in accordance with national and local electrical code regulations.
2. This product is intended to be installed and serviced by a qualified, licensed electrician.
3. Only install with a listed Class 2 DC Constant Voltage LED Driver.
4. Do not modify or disassemble product beyond instructions or this warranty will be void.
5. Actual color may vary from what is pictured above and on other print materials due to the limitations of photographic processes.
6. We reserve the right to modify and improve the design of our fixtures without prior notice. We cannot guarantee to match existing installed fixtures for subsequent orders or replacements in regards to product appearance, CCT, or lumen output.

WARRANTY

Limited Warranty

This product has a twelve (12) year limited warranty from the date of shipment. This warranty does not include the additional accessories referenced in this specification sheet. Complete warranty details for fixtures and additional accessories are available at www.diodeled.com/limited-warranty/ within the Policies section. For warranty related questions please contact product support.

Consumer's Acknowledgment

Elemental LED, Inc. stands behind its products when they are used properly and according to our specifications. By purchasing our products, the purchaser agrees and acknowledges that lighting design, configuration and installation is a complex process, wherein seemingly minor factors or changes in layout and infield adjustments can have a significant impact on an entire system. Choosing the correct components is essential. Elemental LED is able to work with the original purchaser to make an appropriate product selection to the extent of the limited information that the customer can provide, but it is virtually impossible for Elemental LED to design a system that foresees every unknown factor. For this reason, this Warranty does not cover problems caused by improper design, configuration or installation issues. Any statement from an Elemental LED employee or agent regarding a customer's bill of goods and/or purchase order is NOT an acknowledgment that the products purchased are designed and configured correctly. The purchaser agrees and acknowledges that it is the customer's responsibility to adhere strictly to all information contained in the Product Specification Sheets.

There is often more than one way to design, configure and layout an LED lighting application properly to achieve the same lighting effect. Elemental LED strongly recommends that licensed professionals be used in the design and installation of lighting systems that include Elemental LED products. The specifications include important information that a designer and installer should carefully review and strictly follow. Qualified designers and certified and/or licensed installers, with access to the final installation environment, customer goals, and Elemental LED product specifications can make the requisite decisions appropriate for a successful finished lighting application.



© 2018 Elemental LED, Inc. All rights reserved.
Specifications are subject to change without notice.

Toll Free: 877.817.6028 | Fax: 415.592.1596 | www.DiodeLED.com | info@DiodeLED.com